

DIRECT FLOW

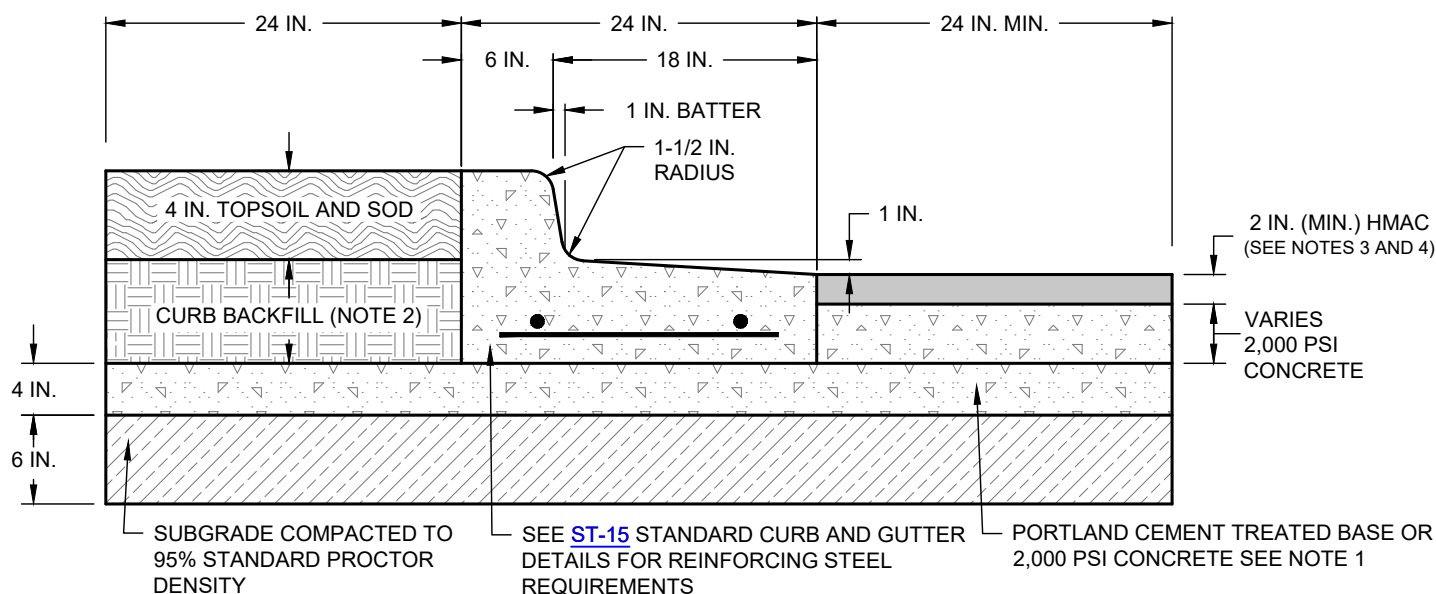

INDIRECT FLOW

NOTES:

1. CURB AND GUTTER SHALL BE PLACED SEPARATELY AFTER BASE OR 2,000 PSI CONCRETE HAS CURED.
2. TYPE "A" MATERIAL PER STANDARD SPECIFICATIONS FOR CONSTRUCTION SECTION 4.2 EXCAVATION AND BACKFILL PART 2: PRODUCT A. MATERIALS 3. TRENCH BACKFILL A. TYPE "A" MATERIAL.
3. HMAc SHALL BE TYPE D FOR STREET CLASSIFICATION LOCAL AND RESIDENTIAL/NEIGHBORHOOD COLLECTOR.
4. HMAc SHALL BE TYPE D FOR STREET CLASSIFICATION OF COMMERCIAL COLLECTOR AND TYPE C FOR INDUSTRIAL COLLECTOR. FOR INDUSTRIAL COLLECTOR DEPTH OF HMAc SHALL BE 3 INCHES.
5. ORIGINAL PLACEMENT OF CURB & GUTTER AND REPLACEMENT OF CURB & GUTTER SHALL BE IN ACCORDANCE WITH THIS STANDARD DETAIL UNLESS SHOWN OTHERWISE IN PLANS APPROVED BY THE CITY.
6. MATERIAL SHALL BE COMPACTED IN ACCORDANCE WITH [G-1C](#).

STANDARD CURB & GUTTER PLACEMENT AND REPLACEMENT DETAILS

(USE FOR EXISTING STREETS ONLY)
(NO SCALE)



ENGINEERING DIVISION

DISCLAIMER: THE USE OF THIS STANDARD IS GOVERNED BY THE "TEXAS ENGINEERING PRACTICE ACT". NO WARRANTY OF ANY KIND IS MADE BY THE CITY OF WACO FOR ANY PURPOSE WHATSOEVER. THE CITY OF WACO ASSUMES NO RESPONSIBILITY FOR THE CONVERSION OF THIS STANDARD TO OTHER FORMATS OR FOR INCORRECT RESULTS OR DAMAGES RESULTING FROM ITS USE.

REVISIONS			
NO.	COMMENTS	BY	DATE
2	MODIFY NOTES 2, 3 & 4; REMOVE MIN DEPTH OF CURB; MOD DEPTH OF TOPSOIL; REMOVE DIM OF BACKFILL	MZ	04/28/2025
1	ADD "A" TO DETAIL NUMBER; ADD REF. TO STD DETAIL	MZ	11/15/2024
##	DESCRIPTION	FL	MM/DD/YYYY

DATE
01/01/2024

ST-20A