

R/NC1^(R) TYPICAL RIGID PAVEMENT SECTION:
RESIDENTIAL/NEIGHBORHOOD COLLECTOR STREET (P.I. ≤ 20)

■ ALL REINFORCEMENT STEEL SHALL BE NO. 4 @ 12 IN. CENTER-TO-CENTER EACH WAY

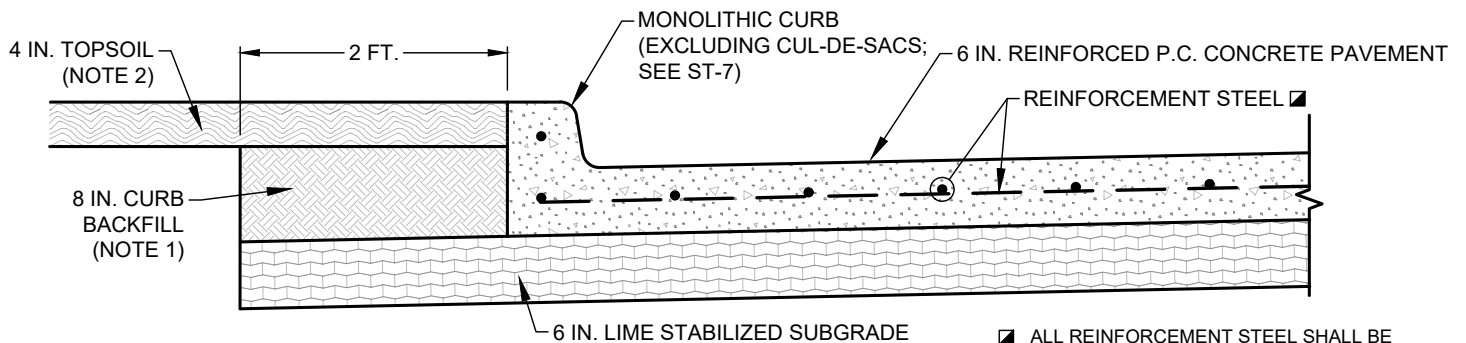

R/NC2^(R) TYPICAL RIGID PAVEMENT SECTION:
RESIDENTIAL/NEIGHBORHOOD COLLECTOR STREET (20 < P.I. < 40)

■ ALL REINFORCEMENT STEEL SHALL BE NO. 4 @ 12 IN. CENTER-TO-CENTER EACH WAY

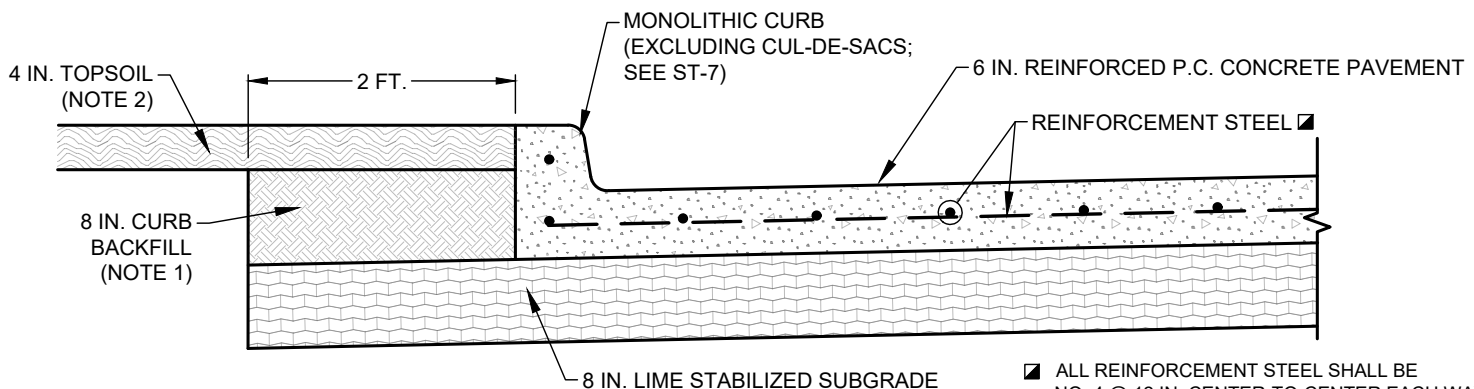

R/NC3^(R) TYPICAL RIGID PAVEMENT SECTION:
RESIDENTIAL/NEIGHBORHOOD COLLECTOR STREET (P.I. ≥ 40)

■ ALL REINFORCEMENT STEEL SHALL BE NO. 4 @ 12 IN. CENTER-TO-CENTER EACH WAY

NOTES:

1. TYPE "A" MATERIAL PER STANDARD SPECIFICATIONS FOR CONSTRUCTION SECTION 4.2 EXCAVATION AND BACKFILL PART 2: PRODUCT A. MATERIALS 3. TRENCH BACKFILL A. TYPE "A" MATERIAL.
2. 4 IN. TOPSOIL W/ SOLID BLOCK SOD OR BERMUDA SEED W/ GREEN SOIL RETENTION BLANKET CLASS 1 TYPE A, B, C, OR D.
3. ALTERNATE: 4 IN. RECYCLED CRUSHED CONCRETE (TXDOT STANDARD SPECIFICATIONS FOR CONSTRUCTION ITEM 247 FLEXIBLE BASE TYPE D GRADE 1-2, EXCLUDING TYPE A MATERIALS, WITH MINIMUM PLASTICITY INDEX OF FOUR) MAY BE SUBSTITUTED FOR 1ST BASE COURSE OF 4 IN. CEMENT-TREATED BASE.
4. COMPACTION OF MATERIALS SHALL BE IN ACCORDANCE WITH THE RELEVANT SPECIFICATIONS WITH SOME HIGHLIGHTS PROVIDED IN G-1 G-1C.

**TYPICAL RIGID PAVEMENT SECTIONS:
RESIDENTIAL/NEIGHBORHOOD COLLECTOR STREETS**

(NO SCALE)



ENGINEERING DIVISION

DISCLAIMER: THE USE OF THIS STANDARD IS GOVERNED BY THE "TEXAS ENGINEERING PRACTICE ACT". NO WARRANTY OF ANY KIND IS MADE BY THE CITY OF WACO FOR ANY PURPOSE WHATSOEVER. THE CITY OF WACO ASSUMES NO RESPONSIBILITY FOR THE CONVERSION OF THIS STANDARD TO OTHER FORMATS OR FOR INCORRECT RESULTS OR DAMAGES RESULTING FROM ITS USE.

REVISIONS			
NO.	COMMENTS	BY	DATE
##	DESCRIPTION	FL	MM/DD/YYYY

DATE
04/28/2025

ST-3F