

***BUFFER STRIP**
 3.5 FT. MIN. FOR LOCAL STREET & MINOR
 COLLECTOR (COMMERCIAL) STREET,
 OTHERWISE 4 FT. MIN. (TYP)

TYPICAL DETAILS OF FRONT OF SIDEWALKS

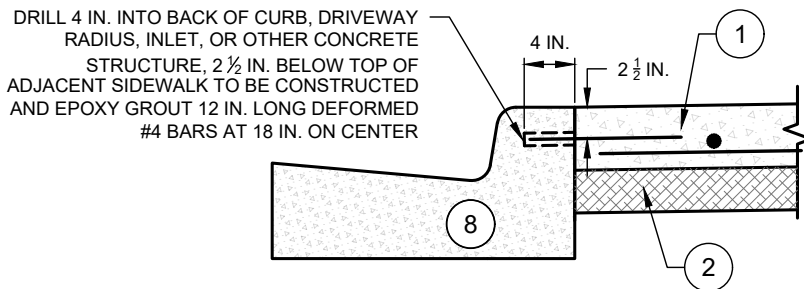

CONSTRUCTION JOINT OF SIDEWALK ADJACENT TO BACK OF CURB, DRIVEWAY RADIUS, INLET, OR OTHER CONCRETE STRUCTURE

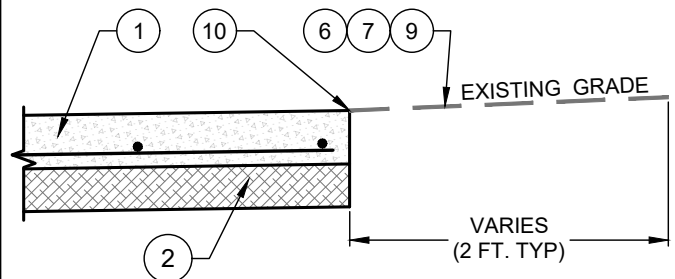

SIDEWALK TO MATCH EXISTING GRADE

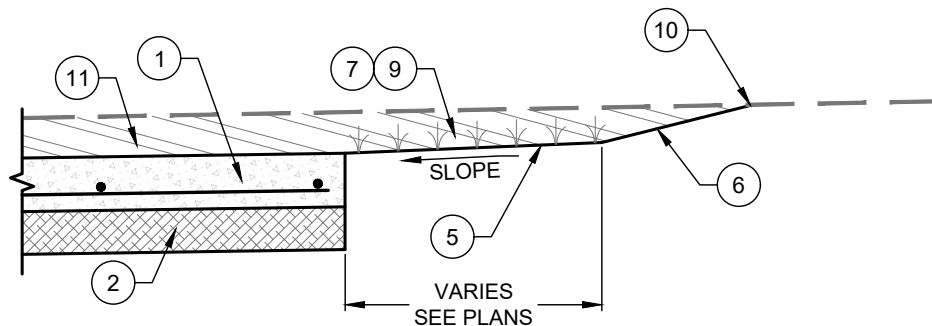

CUT BEHIND SIDEWALK TO MATCH EXISTING GRADE

FOR GENERAL NOTES SEE SHEET [SW-1](#)
 FOR LEGEND DESCRIPTIONS SEE SHEET [SW-2](#)

SIDEWALK DETAILS - 1 OF 2

(NO SCALE)



ENGINEERING DIVISION

DISCLAIMER: THE USE OF THIS STANDARD IS GOVERNED BY THE "TEXAS ENGINEERING PRACTICE ACT". NO WARRANTY OF ANY KIND IS MADE BY THE CITY OF WACO FOR ANY PURPOSE WHATSOEVER. THE CITY OF WACO ASSUMES NO RESPONSIBILITY FOR THE CONVERSION OF THIS STANDARD TO OTHER FORMATS OR FOR INCORRECT RESULTS OR DAMAGES RESULTING FROM ITS USE.

REVISIONS			
NO.	COMMENTS	BY	DATE
1	MODIFY NOTE TO REFERENCE DESIGN CRITERIA AND BUFFER STRIP NOTE IN TOP DETAIL	MZ	04/28/2025
##	DESCRIPTION	FL	MM/DD/YYYY

DATE
01/01/2024

SW-3