

CLASS A
H.M.A.C.
INDUSTRIAL COLLECTOR &
ARTERIAL STREETS

CLASS B
H.M.A.C.
RESIDENTIAL COLLECTOR &
COMMERCIAL COLLECTOR STREETS

CLASS C
H.M.A.C.
LOCAL STREETS

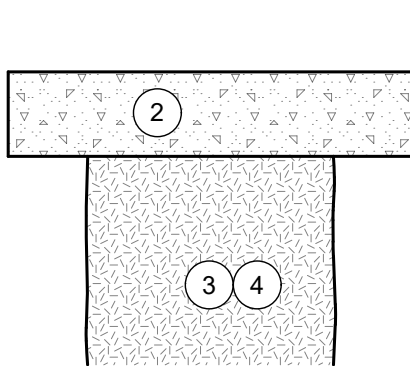

CLASS D
CONCRETE

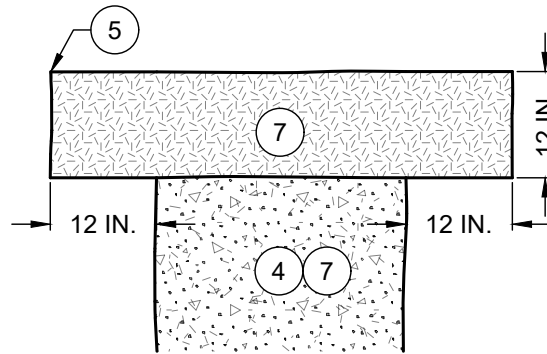

CLASS E
FOR EXISTING NON-BONDED
AGGREGATE SURFACES ONLY

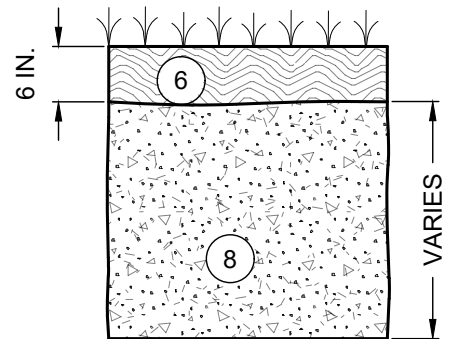

CLASS F
SEED OR SOD

PAVEMENT / SURFACE REPLACEMENT DETAILS

- ① SEE ST-30 AND APPLICABLE ST-33 AND/OR ST-34 FOR SAW CUT AND PAVEMENT REPLACEMENT DETAILS.
- ② SEE ST-37 AND APPLICABLE ST-35 AND/OR ST-36 FOR SAW CUT AND PAVEMENT REPLACEMENT DETAILS.
- ③ TYPE "A" MATERIAL PER STANDARD SPECIFICATIONS FOR CONSTRUCTION, SECTION 4.2 EXCAVATION AND BACKFILL, PART 2: PRODUCT, A. MATERIALS, 3. TRENCH BACKFILL, A. TYPE "A." MATERIAL MECHANICALLY COMPACTED TO 95% OF THE MAXIMUM DRY DENSITY (TEX-113-E) OR CONTROLLED LOW STRENGTH MATERIAL.
- ④ USE CONTROLLED LOW STRENGTH MATERIAL TO BACKFILL ALL TRENCHES 18 IN. OR NARROWER, IN THE RIGHT-OF-WAY AND PUBLIC EASEMENTS.
- ⑤ EDGE TO BE STRAIGHT, SQUARE AND PARALLEL TO SIDES OF TRENCH.
- ⑥ 6 IN. MIN. TOPSOIL AND SEED OR SOD - SUBSIDIARY.
- ⑦ TXDOT ITEM 247 FLEXIBLE BASE TYPE A GRADE 1-2 MINIMUM PLASTICITY INDEX 5.
- ⑧ SEE G-10 FOR BACKFILL MATERIAL REQUIREMENTS AND FOR INSTALLATION.

DISCLAIMER: THE USE OF THIS STANDARD IS GOVERNED BY THE "TEXAS ENGINEERING PRACTICE ACT". NO WARRANTY OF ANY KIND IS MADE BY THE CITY OF WACO FOR ANY PURPOSE WHATSOEVER. THE CITY OF WACO ASSUMES NO RESPONSIBILITY FOR THE CONVERSION OF THIS STANDARD TO OTHER FORMATS OR FOR INCORRECT RESULTS OR DAMAGES RESULTING FROM ITS USE.



**ENGINEERING
DIVISION**



REVISIONS			
NO.	COMMENTS	BY	DATE
1	ADD NOTES	MZ	09/12/2022
##	DESCRIPTION	FL	MO/DY/YEAR

DATE
12/22/2021

G-9